

ASBESTOS ABATEMENT PROJECT DESIGN

PREPARED ESPECIALLY
FOR:

**WILL COUNTY
302 NORTH CHICAGO STREET
JOLIET, IL 60432**

PROJECT LOCATION:

**STATE'S ATTORNEY'S OFFICE
121 NORTH CHICAGO STREET
JOLIET, IL 60432**

MEC PROJECT #: 17-05-358-PD



Consultant:
Midwest Environmental Consulting Services, Inc.
4 Bonnie Lane
Yorkville, IL 60560
Ph. 630.553.3989
Fax 630.553.3990
www.mec-us.com

**CONTRACTOR TO FIELD
VERIFY ALL QUANTITIES:**

Project Designer:

LIC #:

Project Location:
Will County State's Attorney Building
121 North Chicago Street
Joliet, IL 60432

Reference Surveys:
17-05-358-INSP

Client:
Will County
302 North Chicago Street
Joliet, IL 60432

REVISIONS

Number:	Date:	Rev. By:

Drawn By: **CAS** Scale: **NTS**

Date: **00/00/00**

Project No: **17-05-358-PD**

Dwg. No: **G - 0**

COVER SHEET

SITE

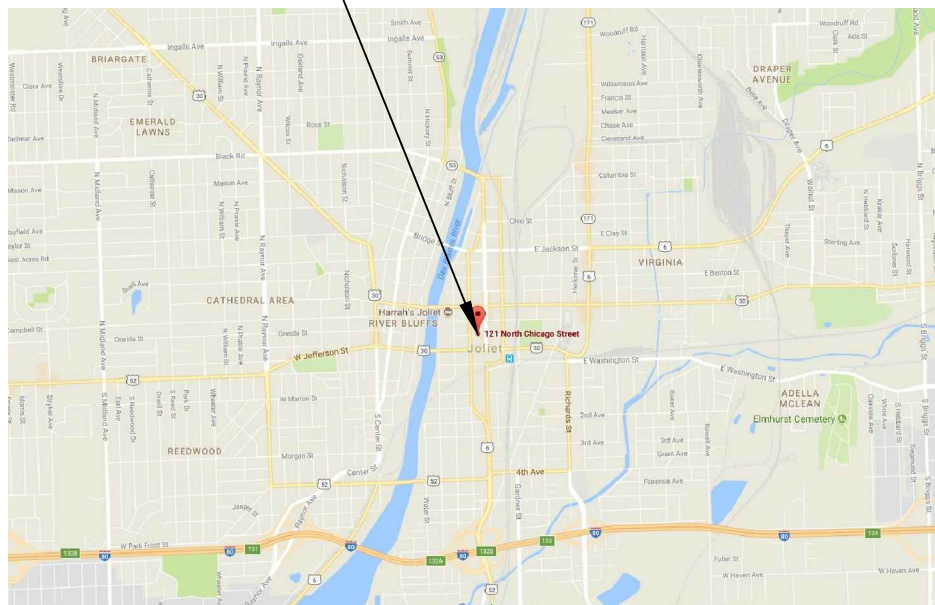

ASBESTOS ABATEMENT DRAWING INDEX

GENERAL:

- G - 0 COVER SHEET
- G - 1 SCOPE OF WORK / GENERAL NOTES
- G - 2 PROJECT OVERVIEW - BUILDING PLAN

PROJECT TIMELINE:

- PRE-BID WALK THROUGH: TBD
- BID DUE DATE: TBD
- PROJECT START: TBD
- PROJECT COMPLETION: TBD

ASBESTOS ABATEMENT PLAN:

- ASB - 1 LOWER LEVEL - ASBESTOS ABATEMENT PLAN - LLA
- ASB - 2 LOWER LEVEL - ASBESTOS ABATEMENT PLAN - LLB
- ASB - 3 1ST FLOOR - ASBESTOS ABATEMENT PLAN - 1A
- ASB - 4 1ST FLOOR - ASBESTOS ABATEMENT PLAN - 1B
- ASB - 5 2ND FLOOR - ASBESTOS ABATEMENT PLAN - 2A
- ASB - 6 2ND FLOOR - ASBESTOS ABATEMENT PLAN - 2B

SITE LOCATION MAP

NTS



LEGEND:

 WORK AREA



Consultant:
Midwest Environmental Consulting Services, Inc.
4 Bonnie Lane
Yorkville, IL 60560
Ph. 630.553.3989
Fax 630.553.3990
www.mec-us.com

**CONTRACTOR TO FIELD
VERIFY ALL QUANTITIES:**

Project Designer:

LIC #:

Project Location:
Will County State's Attorney Building
121 North Chicago Street
Joliet, IL 60432

Reference Surveys:
17-05-358-INSP

Client:
Will County
302 North Chicago Street
Joliet, IL 60432

REVISIONS

Number:	Date:	Rev. By:

Drawn By: **CAS** Scale: **NTS**

Date: **00/00/00**

Project No: **17-05-358-PD**

Dwg. No: **G - 2**

**PROJECT OVERVIEW
BUILDING PLAN**

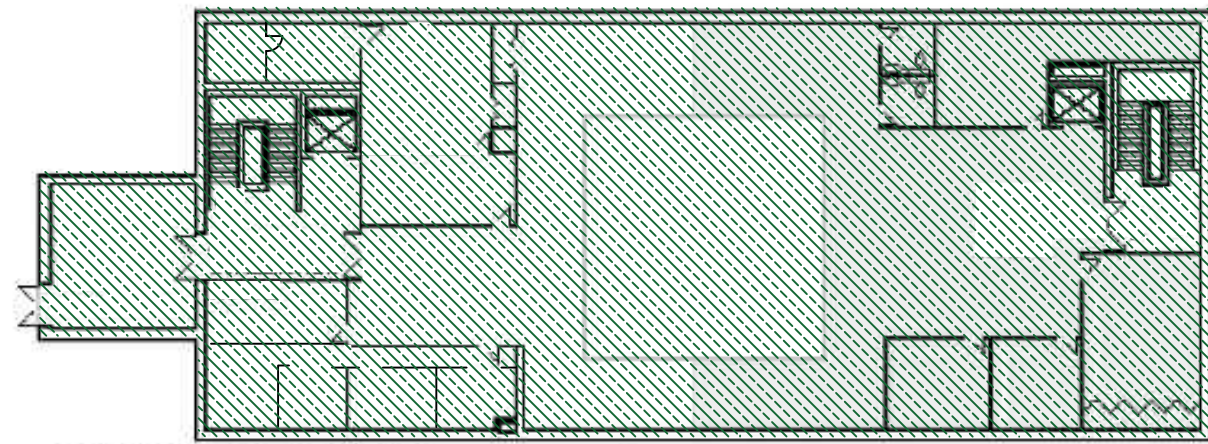

SECOND FLOOR

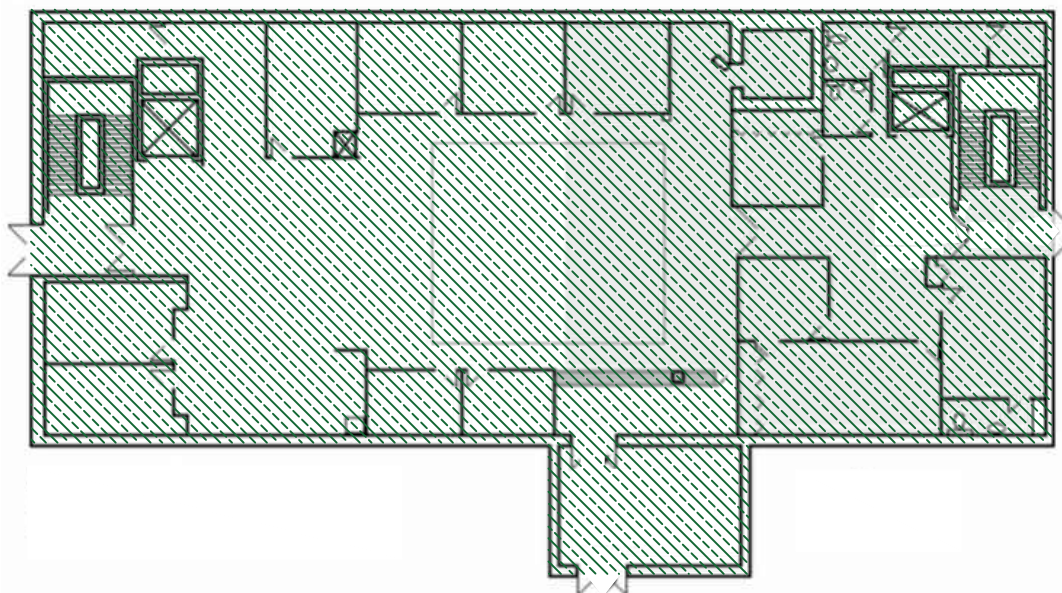

FIRST FLOOR

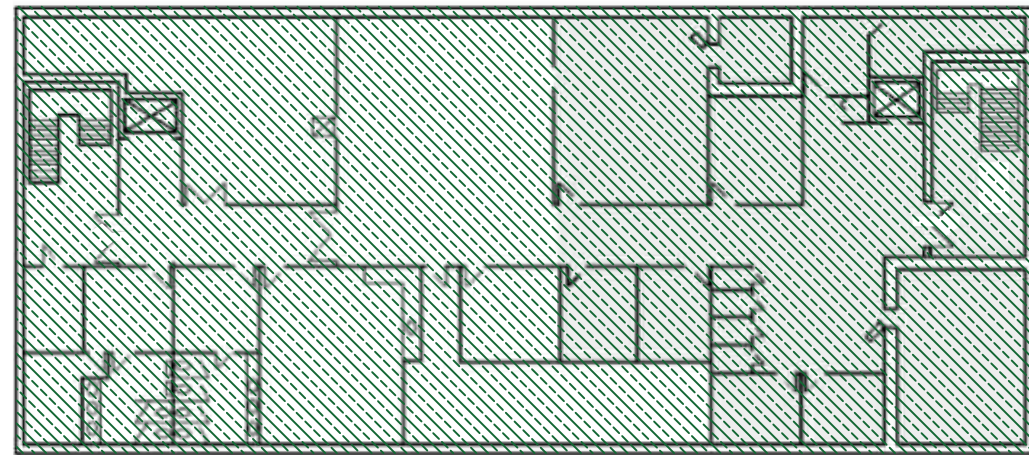



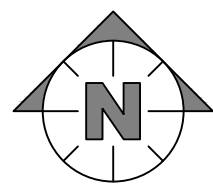







LOWER LEVEL

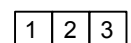
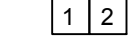

GENERAL ASBESTOS ABATEMENT NOTES:

1. CONTRACTOR SHALL VERIFY ALL CONDITIONS AND DIMENSIONS IN THE FIELD.
2. CONTRACTOR SHALL CHAIN AND LOCK DOOR OR INSTALL SEPARATION BARRIERS TO PREVENT ACCESS BY UNAUTHORIZED PERSONNEL TO THE WORK AREA.
3. NEGATIVE AIR SHALL BE EXHAUSTED OUTSIDE THE WORK AREA.
4. FULL CONTAINMENT WORK AREAS SHALL CONSIST OF CRITICAL SEALS, ONE LAYER OF 6-MIL POLY ON NON-CLEANABLE WALLS, AND ONE LAYER OF 6-MIL POLY ON ALL CARPETED FLOORS, PROVIDED THESE AREAS ARE NOT PART OF ABATEMENT.
5. CONTRACTOR SHALL INSTALL AN ATTACHED 3-CHAMBER DECON TO THE FULL CONTAINMENT WORK AREA.
6. CONTRACTOR SHALL INSTALL AN ATTACHED 2-CHAMBER WASTE-OUT TO THE FULL CONTAINMENT WORK AREA.
7. THE CONTRACTOR SHALL REMOVE DRYWALL WITH TAPE AND JOINT COMPOUND, FLOOR TILE, FLOOR TILE MASTIC, SINK UNDERCOATING, AND FIRE DOORS USING GROSS REMOVAL METHODS WITHIN A FULL-CONTAINMENT WORK AREA.

ABATEMENT LEGEND:

-  LOCATION OF DRYWALL WITH COMPOUND
-  LOCATION OF FLOOR TILE AND MASTIC
-  LOCATION OF SINK UNDERCOATING
-  LOCATION OF WOOD INSULATED FIRE DOORS
-  FULL CONTAINMENT AREA
-  CHAIN AND LOCK DOORS
-  SEPARATION BARRIER
-  3-CHAMBER DECON
-  2-CHAMBER WASTE-OUT
-  NEGATIVE AIR
-  ELECTRICAL SOURCE
-  WATER SOURCE



Consultant:
Midwest Environmental Consulting Services, Inc.
 4 Bonnie Lane
 Yorkville, IL 60560
 Ph. 630.553.3989
 Fax 630.553.3990
 www.mec-us.com

CONTRACTOR TO FIELD VERIFY ALL QUANTITIES:

Project Designer:

LIC #:

Project Location:
 Will County State's Attorney Building
 121 North Chicago Street
 Joliet, IL 60432

Reference Surveys:
 17-05-358-INSP

Client:
 Will County
 302 North Chicago Street
 Joliet, IL 60432

REVISIONS

Number:	Date:	Rev. By:

Drawn By: **CAS** Scale: **NTS**

Date: **00/00/00**

Project No: **17-05-358-PD**

Dwg. No: **ASB - 1**

LOWER LEVEL ASBESTOS ABATEMENT PLAN - LLA

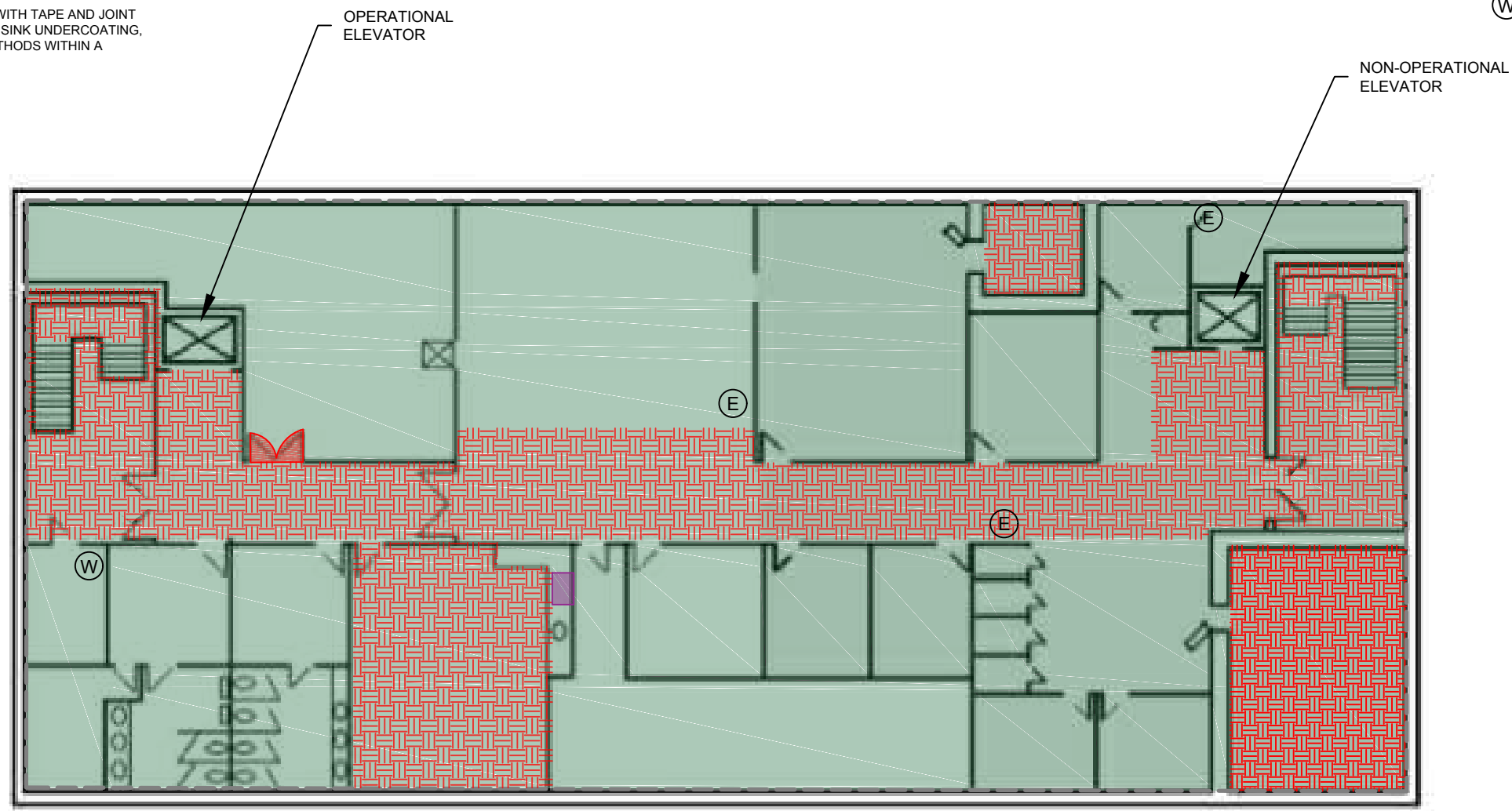



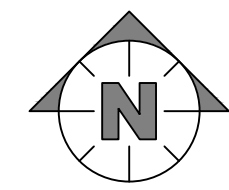



LOWER LEVEL



GENERAL ASBESTOS ABATEMENT NOTES:

1. CONTRACTOR SHALL VERIFY ALL CONDITIONS AND DIMENSIONS IN THE FIELD.
2. CONTRACTOR SHALL CHAIN AND LOCK DOOR OR INSTALL SEPARATION BARRIERS TO PREVENT ACCESS BY UNAUTHORIZED PERSONNEL TO THE WORK AREA.
3. NEGATIVE AIR SHALL BE EXHAUSTED OUTSIDE THE WORK AREA.
4. FULL CONTAINMENT WORK AREAS SHALL CONSIST OF CRITICAL SEALS, ONE LAYER OF 6-MIL POLY ON NON-CLEANABLE WALLS, AND ONE LAYER OF 6-MIL POLY ON ALL CARPETED FLOORS, PROVIDED THESE AREAS ARE NOT PART OF ABATEMENT.
5. CONTRACTOR SHALL INSTALL AN ATTACHED 3-CHAMBER DECON TO THE FULL CONTAINMENT WORK AREA.
6. CONTRACTOR SHALL INSTALL AN ATTACHED 2-CHAMBER WASTE-OUT TO THE FULL CONTAINMENT WORK AREA.
7. THE CONTRACTOR SHALL REMOVE THERMAL SYSTEM INSULATION (TSI), AND LAY-IN CEILING TILES USING GROSS REMOVAL METHODS WITHIN A FULL-CONTAINMENT WORK AREA.

ABATEMENT LEGEND:

-  LOCATION OF LAY-IN CEILING TILE
-  LOCATION OF THERMAL SYSTEM INSULATION
-  FULL CONTAINMENT AREA
-  NEGATIVE AIR
-  ELECTRICAL SOURCE
-  WATER SOURCE



Consultant:
Midwest Environmental Consulting Services, Inc.
 4 Bonnie Lane
 Yorkville, IL 60560
 Ph. 630.553.3989
 Fax 630.553.3990
 www.mec-us.com

CONTRACTOR TO FIELD VERIFY ALL QUANTITIES:

Project Designer:

LIC #:

Project Location:
 Will County State's Attorney Building
 121 North Chicago Street
 Joliet, IL 60432

Reference Surveys:
 17-05-358-INSP

Client:
 Will County
 302 North Chicago Street
 Joliet, IL 60432

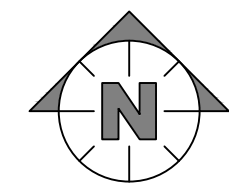
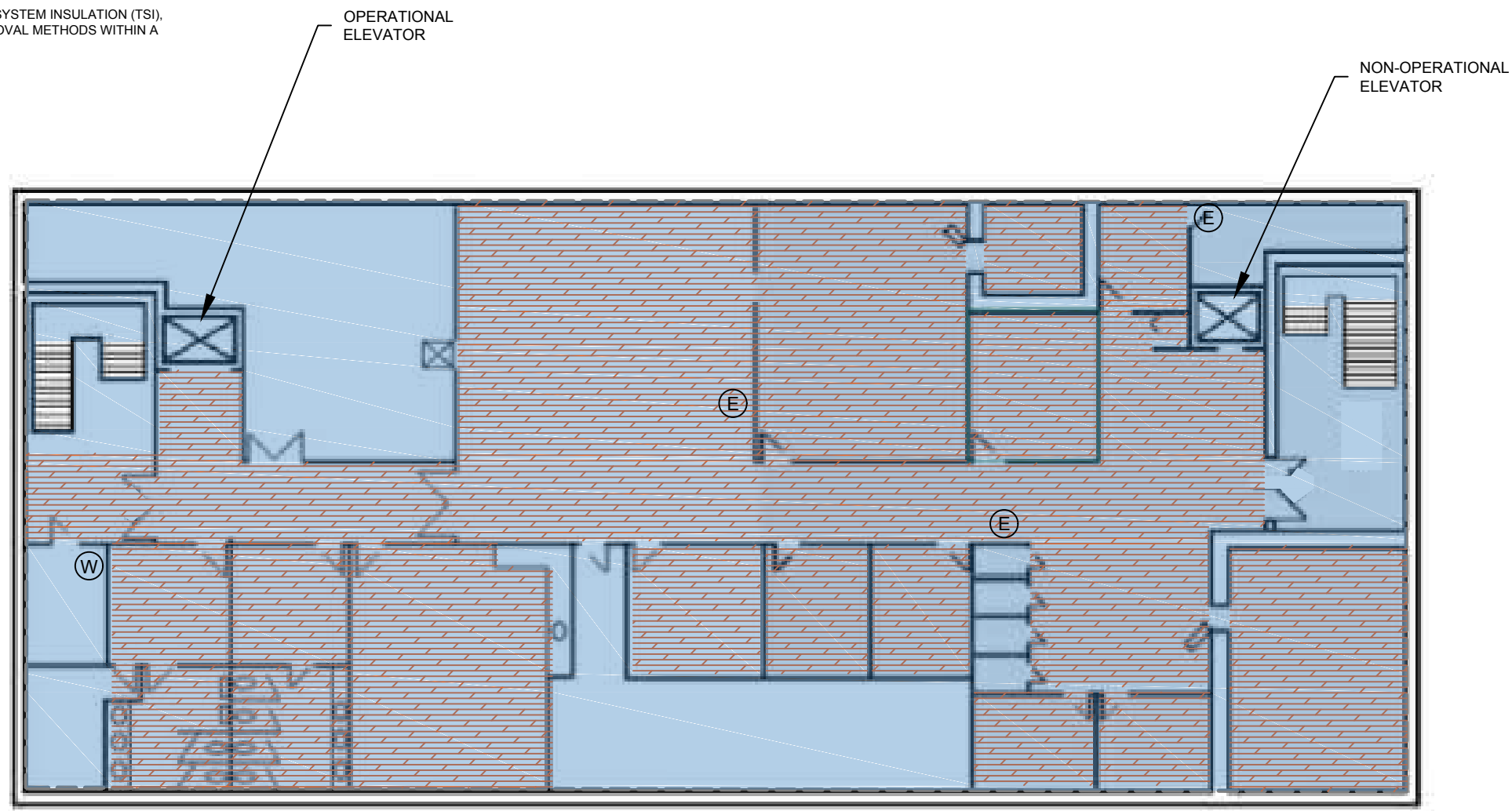









LOWER LEVEL

REVISIONS		
Number:	Date:	Rev. By:
Drawn By:	CAS	Scale: NTS
Date:	00/00/00	
Project No:	17-05-358-PD	
Dwg. No:	ASB - 2	
LOWER LEVEL ASBESTOS ABATEMENT PLAN - LLB		

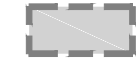
GENERAL ASBESTOS ABATEMENT NOTES:

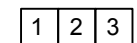
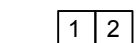
1. CONTRACTOR SHALL VERIFY ALL CONDITIONS AND DIMENSIONS IN THE FIELD.
2. CONTRACTOR SHALL CHAIN AND LOCK DOOR OR INSTALL SEPARATION BARRIERS TO PREVENT ACCESS BY UNAUTHORIZED PERSONNEL TO THE WORK AREA.
3. NEGATIVE AIR SHALL BE EXHAUSTED OUTSIDE THE WORK AREA.
4. FULL CONTAINMENT WORK AREAS SHALL CONSIST OF CRITICAL SEALS, ONE LAYER OF 6-MIL POLY ON NON-CLEANABLE WALLS, AND ONE LAYER OF 6-MIL POLY ON ALL CARPETED FLOORS, PROVIDED THESE AREAS ARE NOT PART OF ABATEMENT.
5. CONTRACTOR SHALL INSTALL AN ATTACHED 3-CHAMBER DECON TO THE FULL CONTAINMENT WORK AREA.
6. CONTRACTOR SHALL INSTALL AN ATTACHED 2-CHAMBER WASTE-OUT TO THE FULL CONTAINMENT WORK AREA.
7. THE CONTRACTOR SHALL REMOVE DRYWALL WITH TAPE AND JOINT COMPOUND, FLOOR TILE, AND FLOOR TILE MASTIC USING GROSS REMOVAL METHODS WITHIN A FULL-CONTAINMENT WORK AREA.

ABATEMENT LEGEND:

-  LOCATION OF DRYWALL WITH COMPOUND
-  LOCATION OF FLOOR TILE AND MASTIC
-  FULL CONTAINMENT AREA
-  CHAIN AND LOCK DOORS
-  SEPARATION BARRIER
-  3-CHAMBER DECON
-  2-CHAMBER WASTE-OUT
-  NEGATIVE AIR
-  ELECTRICAL SOURCE
-  WATER SOURCE



Consultant:
Midwest Environmental Consulting Services, Inc.
 4 Bonnie Lane
 Yorkville, IL 60560
 Ph. 630.553.3989
 Fax 630.553.3990
 www.mec-us.com

CONTRACTOR TO FIELD VERIFY ALL QUANTITIES:

Project Designer:

LIC #:

Project Location:
 Will County State's Attorney Building
 121 North Chicago Street
 Joliet, IL 60432

Reference Surveys:
 17-05-358-INSP

Client:
 Will County
 302 North Chicago Street
 Joliet, IL 60432

REVISIONS

Number:	Date:	Rev. By:

Drawn By: **CAS** Scale: **NTS**

Date: **00/00/00**

Project No: **17-05-358-PD**

Dwg. No: **ASB - 3**

1ST FLOOR ASBESTOS ABATEMENT PLAN - 1A

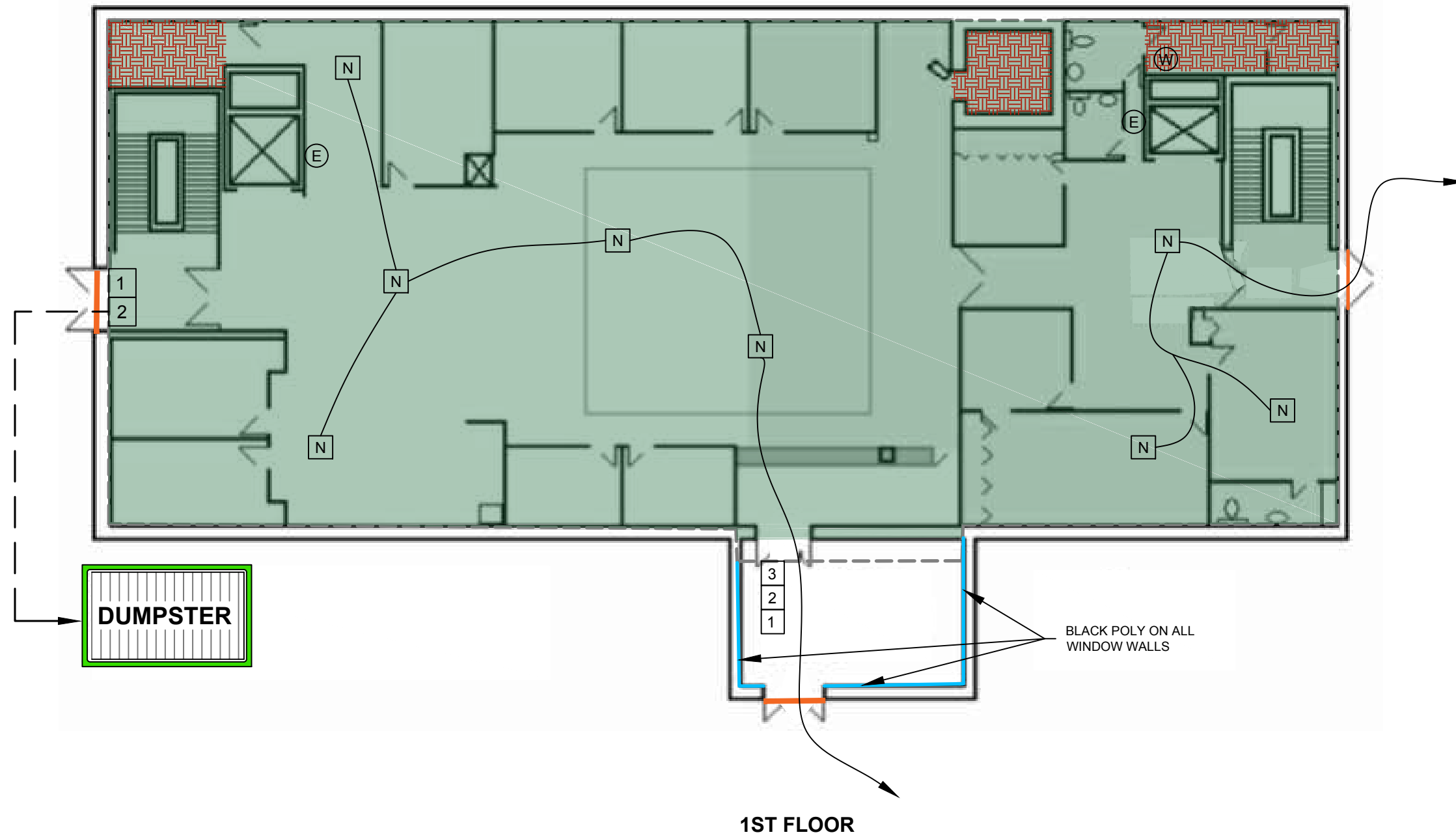









1ST FLOOR

GENERAL ASBESTOS ABATEMENT NOTES:

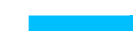
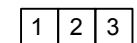
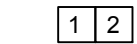
1. CONTRACTOR SHALL VERIFY ALL CONDITIONS AND DIMENSIONS IN THE FIELD.
2. CONTRACTOR SHALL CHAIN AND LOCK DOOR OR INSTALL SEPARATION BARRIERS TO PREVENT ACCESS BY UNAUTHORIZED PERSONNEL TO THE WORK AREA.
3. NEGATIVE AIR SHALL BE EXHAUSTED OUTSIDE THE WORK AREA.
4. FULL CONTAINMENT WORK AREAS SHALL CONSIST OF CRITICAL SEALS, ONE LAYER OF 6-MIL POLY ON NON-CLEANABLE WALLS, AND ONE LAYER OF 6-MIL POLY ON ALL CARPETED FLOORS, PROVIDED THESE AREAS ARE NOT PART OF ABATEMENT.
5. CONTRACTOR SHALL INSTALL AN ATTACHED 3-CHAMBER DECON TO THE FULL CONTAINMENT WORK AREA.
6. CONTRACTOR SHALL INSTALL AN ATTACHED 2-CHAMBER WASTE-OUT TO THE FULL CONTAINMENT WORK AREA.
7. THE CONTRACTOR SHALL REMOVE THERMAL SYSTEM INSULATION (TSI), AND LAY-IN CEILING TILES USING GROSS REMOVAL METHODS WITHIN A FULL-CONTAINMENT WORK AREA.

ABATEMENT LEGEND:

-  LOCATION OF LAY-IN CEILING TILE
-  LOCATION OF THERMAL SYSTEM INSULATION
-  FULL CONTAINMENT AREA
-  CHAIN AND LOCK DOORS
-  SEPARATION BARRIER
-  3-CHAMBER DECON
-  2-CHAMBER WASTE-OUT
-  NEGATIVE AIR
-  ELECTRICAL SOURCE
-  WATER SOURCE



Consultant:
Midwest Environmental Consulting Services, Inc.
 4 Bonnie Lane
 Yorkville, IL 60560
 Ph. 630.553.3989
 Fax 630.553.3990
 www.mec-us.com

CONTRACTOR TO FIELD VERIFY ALL QUANTITIES:

Project Designer:

LIC #:

Project Location:
 Will County State's Attorney Building
 121 North Chicago Street
 Joliet, IL 60432

Reference Surveys:
 17-05-358-INSP

Client:
 Will County
 302 North Chicago Street
 Joliet, IL 60432

REVISIONS		
Number:	Date:	Rev. By:

Drawn By: **CAS** Scale: **NTS**

Date: **00/00/00**

Project No: **17-05-358-PD**

Dwg. No: **ASB - 4**

1ST FLOOR ASBESTOS ABATEMENT PLAN - 1B

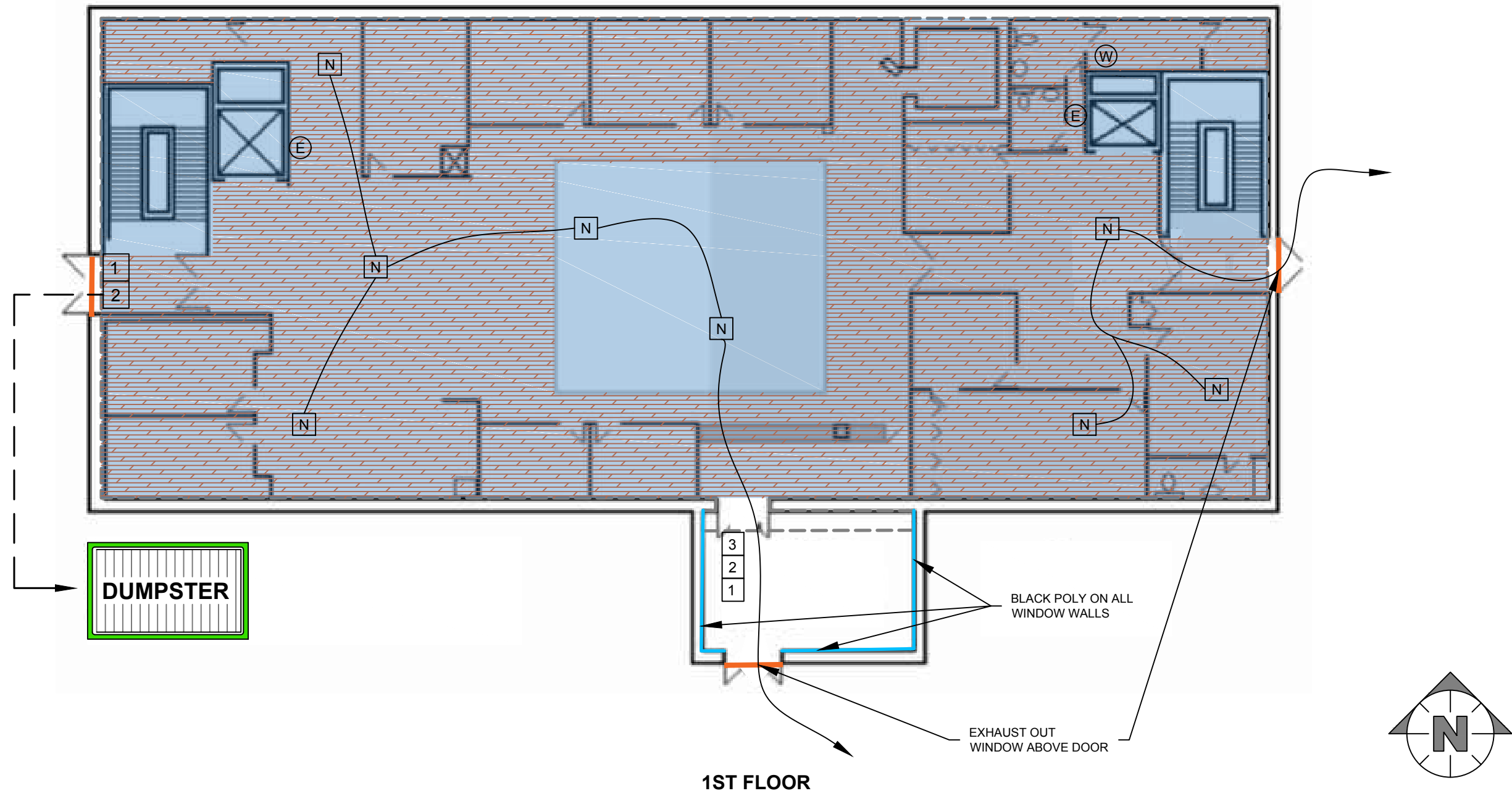







1ST FLOOR

GENERAL ASBESTOS ABATEMENT NOTES:

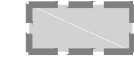
1. CONTRACTOR SHALL VERIFY ALL CONDITIONS AND DIMENSIONS IN THE FIELD.
2. CONTRACTOR SHALL CHAIN AND LOCK DOOR OR INSTALL SEPARATION BARRIERS TO PREVENT ACCESS BY UNAUTHORIZED PERSONNEL TO THE WORK AREA.
3. NEGATIVE AIR SHALL BE EXHAUSTED OUTSIDE THE WORK AREA.
4. FULL CONTAINMENT WORK AREAS SHALL CONSIST OF CRITICAL SEALS, ONE LAYER OF 6-MIL POLY ON NON-CLEANABLE WALLS, AND ONE LAYER OF 6-MIL POLY ON ALL CARPETED FLOORS, PROVIDED THESE AREAS ARE NOT PART OF ABATEMENT.
5. CONTRACTOR SHALL INSTALL AN ATTACHED 3-CHAMBER DECON TO THE FULL CONTAINMENT WORK AREA.
6. CONTRACTOR SHALL INSTALL AN ATTACHED 2-CHAMBER WASTE-OUT TO THE FULL CONTAINMENT WORK AREA.
7. THE CONTRACTOR SHALL REMOVE DRYWALL WITH TAPE AND JOINT COMPOUND, FLOOR TILE, FLOOR TILE MASTIC AND A FIRE DOOR USING GROSS REMOVAL METHODS WITHIN A FULL-CONTAINMENT WORK AREA.

ABATEMENT LEGEND:

-  LOCATION OF DRYWALL WITH COMPOUND
-  LOCATION OF FLOOR TILE AND MASTIC
-  LOCATION OF WOOD INSULATED FIRE DOORS
-  FULL CONTAINMENT AREA
-  CHAIN AND LOCK DOORS
-  NEGATIVE AIR
-  ELECTRICAL SOURCE
-  WATER SOURCE



Consultant:
Midwest Environmental Consulting Services, Inc.
 4 Bonnie Lane
 Yorkville, IL 60560
 Ph. 630.553.3989
 Fax 630.553.3990
 www.mec-us.com

CONTRACTOR TO FIELD VERIFY ALL QUANTITIES:

Project Designer:

LIC #:

Project Location:
 Will County State's Attorney Building
 121 North Chicago Street
 Joliet, IL 60432

Reference Surveys:
 17-05-358-INSP

Client:
 Will County
 302 North Chicago Street
 Joliet, IL 60432

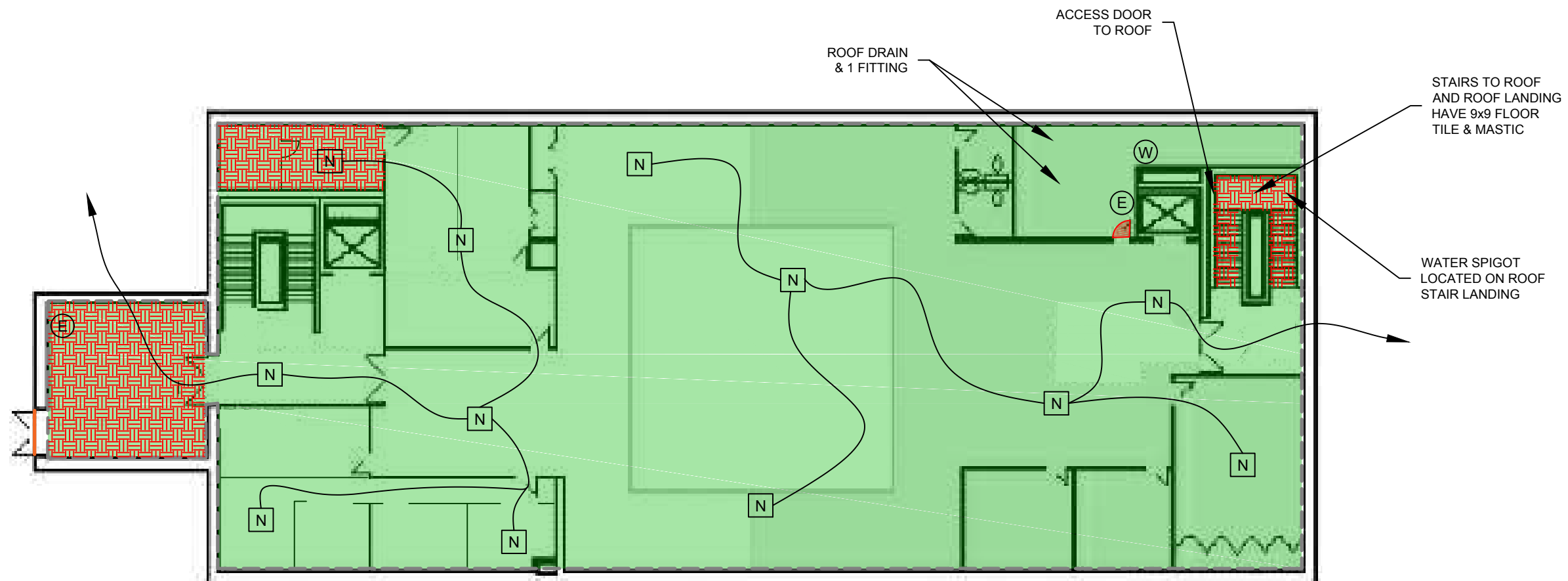

2ND FLOOR

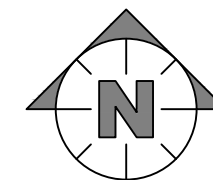

REVISIONS

Number:	Date:	Rev. By:

Drawn By: **CAS** Scale: **NTS**

Date: **00/00/00**

Project No: **17-05-358-PD**

Dwg. No: **ASB - 5**

2ND FLOOR ASBESTOS ABATEMENT PLAN - 2A

